

NEUSPEED®

UPPER REAR STRESS BAR FOR 2001-up ACURA RSX

PART # 80.20.48P

INSTALLATION INSTRUCTIONS

PARTS LIST:	2 – STRESS BAR ENDS	4 – M10 INSERTS
	1 – STRESS BAR	4 – M10 WASHERS
	4 – M10 X 35 BOLTS	1 – 4mm HEX KEY WRENCH
	4 – M6 FLAT HEAD SOCKET CAP SCREWS	1 – INSERT INSTALLATION TOOL

TOOLS REQUIRED:	1 – 14mm SOCKET	1 – DRILL MOTOR WITH $\geq 1/2$ " CHUCK
	1 – 17mm SOCKET	1 – 25/64" DIAMETER DRILL
	1 – 16mm WRENCH	1 – 1/2" DIAMETER DRILL
	1 – 17mm WRENCH	1 – X-ACTO STYLE KNIFE
	1 – TORQUE WRENCH	

NOTE: IN ORDER TO OBTAIN CORRECT STRESS BAR ALIGNMENT, THE FOLLOWING INSTALLATION SEQUENCE MUST BE FOLLOWED.

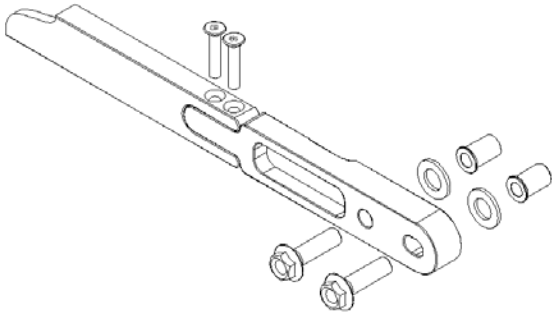

1. Stress bar assembly (Right side shown)



2. Remove left and right rear panels from cargo area. (Right side shown)



3. Enlarge existing hole in bulkhead by drilling 1/2" hole through first panel. (Right side shown. Repeat for left side)



4. Position supplied M10 insert (pre-assembled on tool) in 1/2" hole. Use a 16mm wrench to hold tool stationary and turn bolt clockwise with 17mm wrench. Be sure to keep insert flush with bulkhead while tightening bolt. Torque to 25 ft/lbs. To remove, turn bolt counter-clockwise while holding tool stationary. (Right side shown. Repeat for left side)



5. Assemble bar with supplied M6 F.H.S.C. and install using supplied M10 x 35 bolts in outer (slotted) hole locations (14mm hex). Drill inner hole with 25/64" drill as shown. Remove bar and drill with 1/2" drill. Install insert in new hole by repeating step 3. (Right side shown. Repeat for left side)



6. Place M10 washers in counter bores on front side of bar ends as shown. Install bar with four (4) supplied M10 x 35 bolts and torque to 25 ft/lbs.

7. Remove center bar by removing four flat head cap screws with supplied M4 hex wrench.

8. Using X-Acto style knife, cut an opening in panel for bar end to pass through. (Repeat for opposite side)



9. Install left and right rear side panels. (Right side shown)



10. Install center bar using supplied hex key or M4 hex key socket. (Left side shown) Store hex key in vehicle for future use.



11. Installation complete.

NOTE: If you are using the child seat tether at the rear of the cargo area, route tether over seat back and stress bar. Secure child seat pursuant to seat and vehicle manufacturer's instruction

©Copyright 2002, NEUSPEED®. All rights reserved. Reproduction in whole or in part prohibited
DOC.80.20.48P Rev. 09.17.02

